

## Ermeto

### Male connector

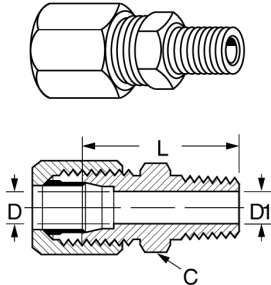

#### Part no. 7205x (Ref. SAE No. 080102)

Part number	Tube O.D.	Male pipe thread	Hex C	D1 D	Opt.	L
7205x2	1/8	1/8	7/16	0.093	0.188	1.04
7205x2X4	1/8	1/4	9/16	0.093	0.281	1.25
7205x3	3/16	1/8	7/16	0.125	0.188	1.09
7205x4	1/4	1/8	1/2	0.203	0.188	1.12
7205x4X4	1/4	1/4	9/16	0.203	0.281	1.32
7205x4X6	1/4	3/8	3/4	0.203	0.406	1.33
7205x4X8	1/4	1/2	7/8	0.203	0.531	1.58
7205x5	5/16	1/8	9/16	0.234	0.188	1.12
7205x5X4	5/16	1/4	9/16	0.234	0.281	1.32
7205x6	3/8	1/4	5/8	0.281	0.281	1.34
7205x6X2	3/8	1/8	5/8	0.281	0.188	1.15
7205x6X6	3/8	3/8	3/4	0.281	0.406	1.35
7205x6X8	3/8	1/2	7/8	0.281	0.531	1.60
7205x8	1/2	3/8	13/16	0.422	0.406	1.44
7205x8X4	1/2	1/4	13/16	0.422	0.281	1.44
7205x8X8	1/2	1/2	7/8	0.422	0.531	1.69
7205x8X12	1/2	3/4	1 1/8	0.422	0.719	1.76
7205x10	5/8	1/2	15/16	0.500	0.531	1.75
7205x10X6	5/8	3/8	15/16	0.500	0.406	1.56
7205x12	3/4	1/2	1 1/8	0.656	0.531	1.88
7205x12X8	3/4	3/4	1 1/8	0.656	0.719	1.88
7205x14	7/8	3/4	1 1/4	0.718	0.719	1.88
7205x16	1	1	1 3/8	0.875	0.938	2.07
7205x16X12	1	3/4	1 3/8	0.875	0.719	1.88
7205x20	1 1/4	1 1/4	1 11/16	1.093	1.250	2.18
7205x24	1 1/2	1 1/2	2	1.344	1.500	2.28
7205x32	2	2	2 5/8	1.813	1.938	2.46

### Female connector

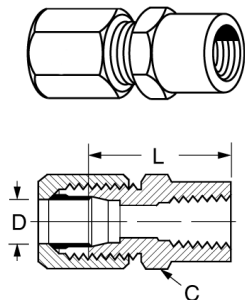

#### Part no. 7255x (Ref. SAE No. 080103)

Part number	Fern Tube O.D.	Pipe thread	Hex C	D	L
7255x2	1/8	1/8	9/16	0.093	1.05
7255x3	3/16	1/8	9/16	0.125	1.08
7255x4	1/4	1/8	9/16	0.203	1.09
7255x4x4	1/4	1/4	3/4	0.203	1.20
7255x5	5/16	1/8	9/16	0.234	1.08
7255x6	3/8	1/4	3/4	0.281	1.31
7255x6x6	3/8	3/8	7/8	0.281	1.40
7255x8	1/2	3/8	7/8	0.422	1.47
7255x8x4	1/2	1/4	7/8	0.422	1.38
7255x8x8	1/2	1/2	1 1/8	0.422	1.63
7255x10	5/8	1/2	1 1/8	0.500	1.76
7255x12	3/4	3/4	1 3/8	0.656	1.89
7255x14	7/8	3/4	1 3/8	0.718	1.86
7255x16	1	1	1 5/8	0.875	2.13
7255x20	1 1/4	1 1/4	2	1.093	2.22

Note: All measurements are in inches.