

# Flare connecting parts for flare tube fittings

## BO-DR ...

### BO-DR ... 1.4571

- Sleeve

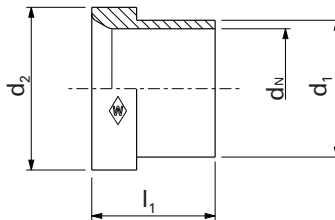

D

Sleeve  
stainless steel (1.4571)  
BO-DR ...  
-1.4571

Sleeve  
BO-DR ...

Series	PN bar (psi)	Tube outer diameter $d_N$	Model	kg/ 100 pc.	$d_1$	$d_2$	$l_1$	Art. no.	Art. no.
L	500 (7252)	6	<b>BO-DR 6 L/S</b>	0.2	7.6	10.2	10.5	<b>WAL374376</b>	<b>WAL602973</b>
		8	<b>BO-DR 8 L/S</b>	0.3	9.3	12.2	11.0	<b>WAL374377</b>	<b>WAL602974</b>
		10	<b>BO-DR 10 L/S</b>	0.4	11.5	14.2	12.5	<b>WAL374378</b>	<b>WAL602975</b>
	400 (5801)	12	<b>BO-DR 12 L/S</b>	0.5	13.6	16.2	13.0	<b>WAL374379</b>	<b>WAL602976</b>
		15	<b>BO-DR 15 L</b>	0.9	17.5	20.2	14.0	<b>WAL374380</b>	<b>WAL602977</b>
		18	<b>BO-DR 18 L</b>	1.4	21	24.2	14.5	<b>WAL374381</b>	<b>WAL602978</b>
	250 (3626)	22	<b>BO-DR 22 L</b>	1.6	24.2	27.8	18.0	<b>WAL374382</b>	<b>WAL602979</b>
		28	<b>BO-DR 28 L</b>	2.0	30.2	33.8	17.0	<b>WAL374383</b>	<b>WAL602980</b>
		35	<b>BO-DR 35 L</b>	3.7	38	42.7	19.0	<b>WAL374384</b>	<b>WAL602981</b>
		42	<b>BO-DR 42 L</b>	5.0	45	49.7	21.0	<b>WAL374385</b>	<b>WAL602982</b>
S	630 (9137)	6	<b>BO-DR 6 L/S</b>	0.2	7.6	10.2	10.5	<b>WAL374376</b>	<b>WAL602973</b>
		8	<b>BO-DR 8 L/S</b>	0.3	9.3	12.2	11.0	<b>WAL374377</b>	<b>WAL602974</b>
		10	<b>BO-DR 10 L/S</b>	0.4	11.5	14.2	12.5	<b>WAL374378</b>	<b>WAL602975</b>
	400 (5801)	12	<b>BO-DR 12 L/S</b>	0.5	13.6	16.2	13.0	<b>WAL374379</b>	<b>WAL602976</b>
		14	<b>BO-DR 14 S</b>	1.2	17.5	20.2	14.5	<b>WAL374386</b>	<b>WAL602983</b>
		16	<b>BO-DR 16 S</b>	1.3	18.5	22.0	17.0	<b>WAL374387</b>	<b>WAL602984</b>
	400 (5801)	20	<b>BO-DR 20 S</b>	2.4	24.2	27.8	17.5	<b>WAL374388</b>	<b>WAL602985</b>
		25	<b>BO-DR 25 S</b>	3.1	28.5	32.8	20.0	<b>WAL374389</b>	<b>WAL602986</b>
		30	<b>BO-DR 30 S</b>	4.5	34	39.0	21.5	<b>WAL374390</b>	<b>WAL602987</b>
		38	<b>BO-DR 38 S</b>	7.5	42	48.5	26.5	<b>WAL374391</b>	<b>WAL602988</b>

**⚠ Caution:** The pressure specifications refer to the steel version. For the stainless steel version (1.4571), please refer to the pressure specifications on page B5.